

GUMO K

SUBSTRUCTURE PROTECTION & INSULATION TAPE



GUMO K is a self-adhesive protection and insulation tape for wood and aluminium substructures.

GUMO K permanently protects the top of wooden substructures from dirt and water accumulation.

GUMO K insulates the contact surface between a concealed fastener and the substructure, e.g. DILA on a RELO substructure rail.

The rubber-like material is highly resilient and delivers perfect functionality in its application.

The practical and handy 10 metre roll makes installation quick and easy.

OVERVIEW

Dimensions:	Roll length 10 m Width 75 mm
Material:	HDPE Polyethylene black Butyl rubber UV and weather resistant
Fastening type:	Self-adhesive tape for wood, aluminium, stainless steel, ... Adhesive surfaces must be dry and dust-free

GUMO K

Description	PU	Prod. No.
Roll 10 metres	10 ROL	011912000

BRANDING
Custom branding
upon request



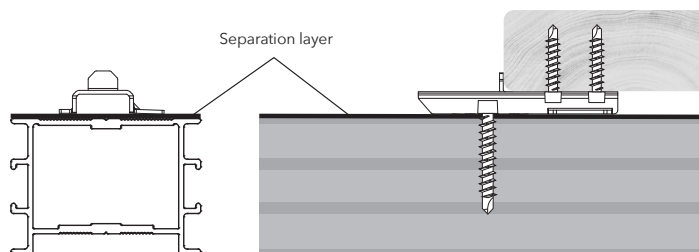
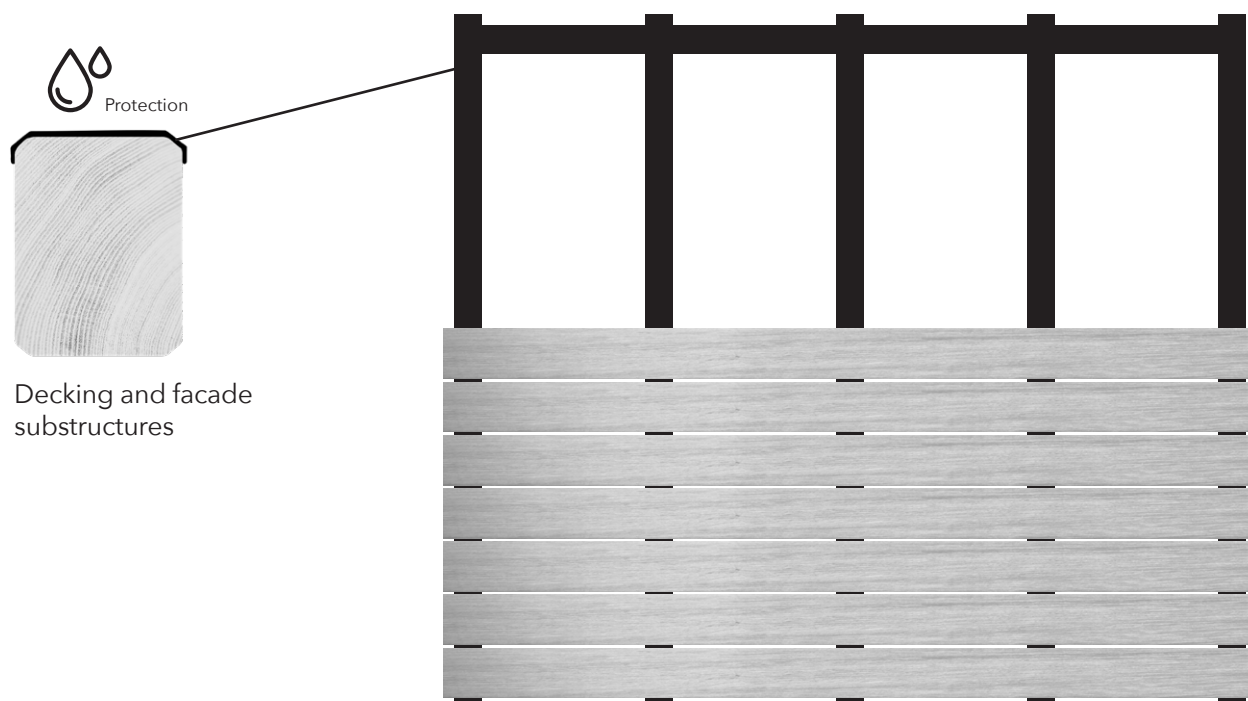
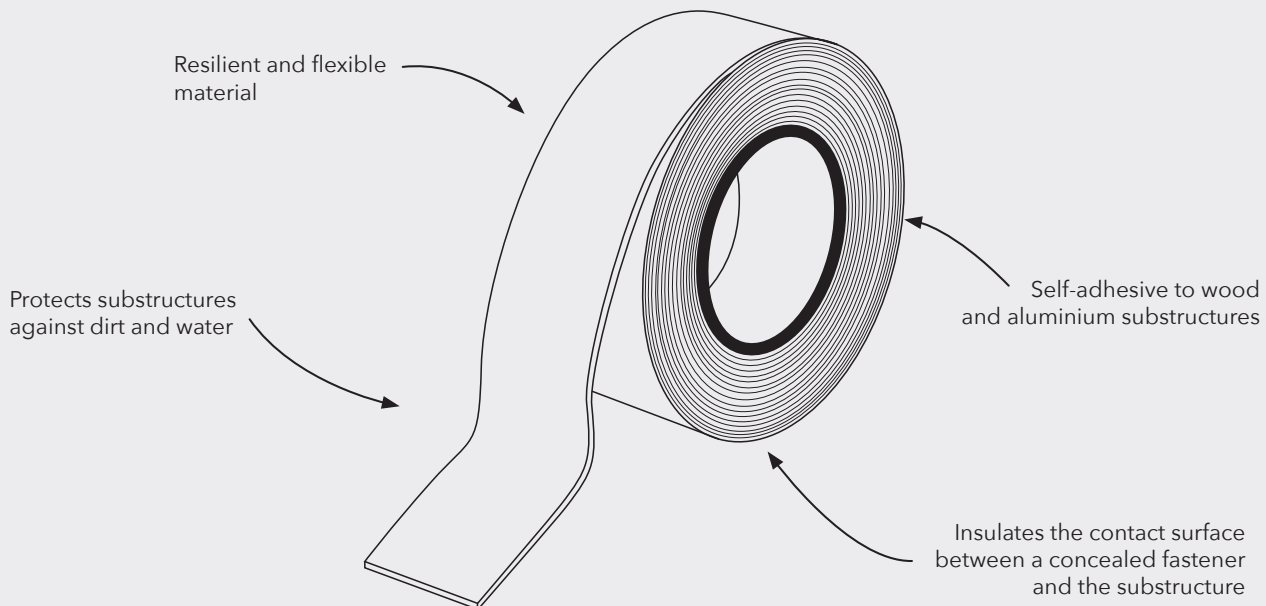

DOWNLOADS

Data sheet	Tips & Tricks	Video